

# PTI In2iT SERIES

## Page Talk Indoor



In2iT Page/Talk Indoor (PTI) Handset Station

### FEATURES and BENEFITS

- 5 Independent talk lines are standard
- Microprocessor controlled for increased functionality and configurability
- Real time continuous self-monitoring / diagnostics to reduce maintenance costs
- 30w integrated paging amplifier
- 4 Optically isolated inputs for local device monitoring
- 2 Dry contact outputs for connection to external devices (i.e., beacon, door locks)
- Operator direct call button with multi-color device status indicator lets you know if station is powered and active, in page mode, or in a fault state condition
- Large 35mm controls for ease of use when wearing work gloves
- Wide range power input: 90vac – 250VAC: 50/60hz
- Noise cancelling microphone in handset
- Faceplates are easily interchangeable



### In2iT RANGE

The In2iT Range is Guardian Telecom's next generation In-Plant Communications platform with the latest technology and easy to use, rugged communication equipment to solve In-Plant Paging concerns while maximizing integration options and easing implementation costs.

### PTI In2iT SERIES

Guardian Telecom's Page Talk Indoor In2iT Zone 2 Stations provide easy to operate paging with the versatility of five intercommunication talk lines for two or more people. The stations feature continuous real time self-diagnostics and the flexibility of monitoring external devices via two optically isolated inputs when used with Guardian Telecom's In2iT In-Plant Communications platform.

Designed for use for harsh indoor harsh environments and features a IECEx Zone2 hazardous environmental certification.

### APPLICATIONS

The In2iT system is designed to provide in plant communications, paging and alarm monitoring in harsh environments that are subject to moisture, dust and corrosive chemicals such as:

- |                       |   |
|-----------------------|---|
| Mines                 | Grain Processing and Similar Industries |
| Chemical Plants       | Power Generation Facilities             |
| Refineries            | Fertilizer Plants                       |
| Drilling Rigs         | Food Processing Plants                  |
| Defense Installations | Sewage Plants                           |
| Cement Plants         | Construction Sites                      |
| Bulk Loading Stations | Breweries & Distilleries                |
| Pulp & Paper Mills    | Pharmaceutical Plants                   |
|                       | and more . . .                          |



tough. trusted. true.



## OVERALL DIMENSIONS

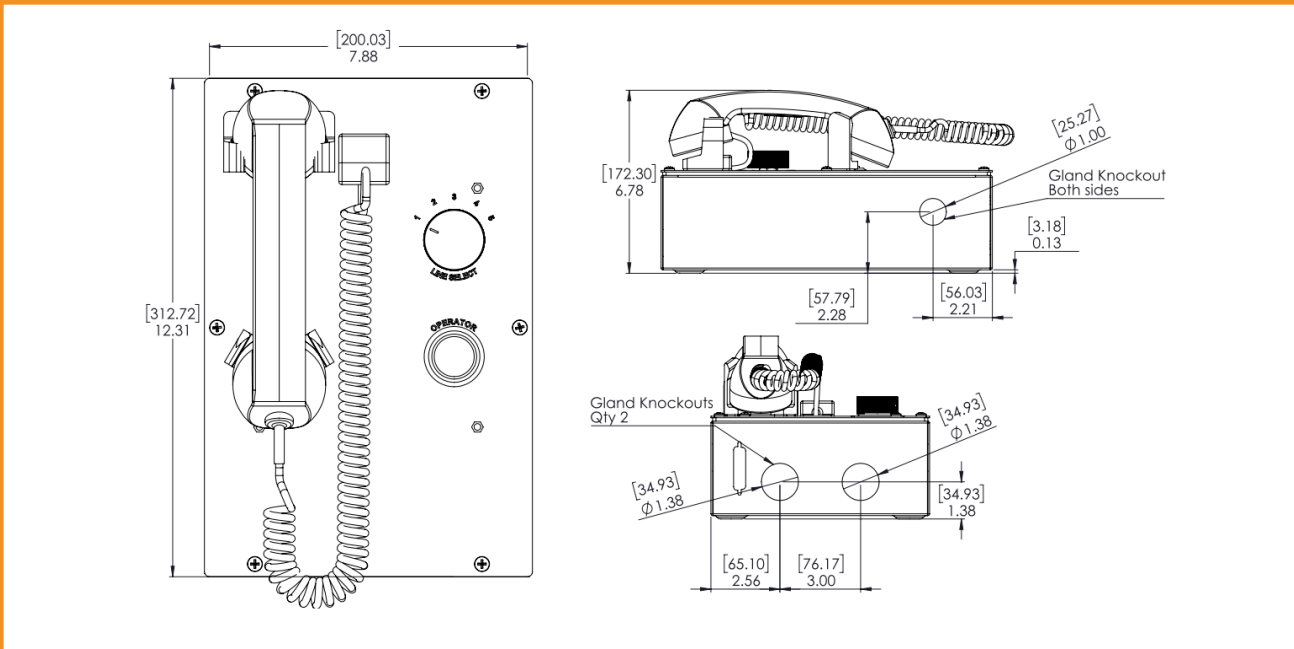

PTI - In2iT SERIES Page Talk Indoor Zone 2 Stations

## ENGINEERING SPECIFICATIONS

### ELECTRICAL REQUIREMENTS

Input Voltage:	90VAC – 250VAC; 50/60 Hz
Current (Nominal):	<500 mA
Current (In-Rush):	0.5A @ 120VAC 0.25A @ 220VAC
Optical Input 1 -4:	1mA nom
Dry Contact Relays (Non-Fused):	3A @ 120VAC
Fuse:	4 A

### SPEAKER AMPLIFIER

Amplifier Max Output Power:	30 W
Amplifier Gain:	Configurable gain: 20, 26, 32, 36 dB
Frequency Response:	300 – 3400 Hz
Total Harmonic Distortion:	<1.0% Max @ 1KHz

### MECHANICAL SPECIFICATIONS

Body Construction:	Powder coated, corrosion protected CRS
Faceplate Construction:	Powder coated, corrosion protected CRS
Net Weight:	9 lbs [4.1 kg]
Overall Mechanical Dimensions (L x W x D):	7.88" [200mm] x 12.3" [323mm] x 6.8" [172mm]
Shipping Weight:	12 lbs [5.5 kg]
Shipping Dimensions (L x W x D):	16.0" [407mm] x 10.5" [267mm] x 9.5" [242 mm]

\* Contact Guardian for details for connection to external device inputs for monitoring.

\*\* Stations can be direct wired to legacy Guardian systems however the systems control frame is necessary to take advantage of the monitoring and automation.

### ENVIRONMENTAL

Indoor Unit Weather Rating:	IP-54
Operating Temperature (Normal Locations):	-40Fto +158F[-40C to +70C]
Humidity:	0-95% RH non-condensing

### COMPLIANCE / CERTIFICATIONS

IECEX	Zone 2
	II 3G EX e T5
	II 3D Ex e IIIC
	-40C<=Ta<=+60C

### ORDERING INFORMATION

Warranty: Five year parts and labor

Order No.	Description
P6715	Five Line Station

Distributed by:



GUARDIAN TELECOM LTD.  
Calgary, Alberta, Canada  
Telephone: 403 258 3100 Facsimile: 403 255 2595  
1 800 363 8010 (North America)  
info@guardiantelecom.com | www.guardiantelecom.com

