



EIM - In2iT SERIES

Enhanced Interface Module

FEATURES and BENEFITS

- Real time continual self monitoring of internal systems and external transducer devices
- Speaker volume management (remote controlled tapping)
- 4 Optically isolated inputs for monitor of external devices (ie: panic switch)
- 4 Dry contact outputs rated for 5A (ideal for control of beacons, sounders, etc)
- Wide range power input: 90VAC – 250VAC – from system distribution cable
- Offered for normal locations, Hazloc & IECEx hazardous locations

** Contact Guardian engineers for details in connecting to external device inputs for monitoring*

CONTROLS

- Configuration via Guardian's Operator Access Panel for :
 - Defining inputs and activation actions
 - Manual or automatic control of dry contact outputs (based on system activity)
 - Switched tapped audio transformer for 70V/100V paging line

In2iT RANGE

The In2iT Range is Guardian Telecom's next generation In-Plant Communications platform with the latest technology and easy to use, rugged communication equipment to solve In-Plant Paging concerns while maximizing integration options and easing implementation costs.

EIM - In2iT SERIES

Guardian Telecom's Enhanced Interface Module (EIM) is a small multi-function Interface module that is the ideal endpoint for interaction with 3rd party devices. The EIM provides the means to monitor and control such devices including adjusting paging speaker volume levels remotely on central paging systems.

The stations feature continual real time self diagnostics and offer the flexibility of monitoring external devices via 4 opto isolated inputs when used with Guardian Telecom's System Control Frame (SCF).

All stations have been designed for use in harsh environments and offer an IECex Zone 2 Hazardous certification rating.

APPLICATIONS

The In2iT system is designed to provide in plant communications, paging and alarm monitoring in harsh environments that are subject to moisture, dust and corrosive chemicals such as:

- | | |
|-----------------------|---|
| Mines | Grain Processing and Similar Industries |
| Chemical Plants | Power Generation Facilities |
| Refineries | Fertilizer Plants |
| Drilling Rigs | Food Processing Plants |
| Defense Installations | Sewage Plants |
| Cement Plants | Construction Sites |
| Bulk Loading Stations | Breweries & Distilleries |
| Pulp & Paper Mills | Pharmaceutical Plants |
| | and more . . . |



tough. trusted. true.



OVERALL DIMENSIONS

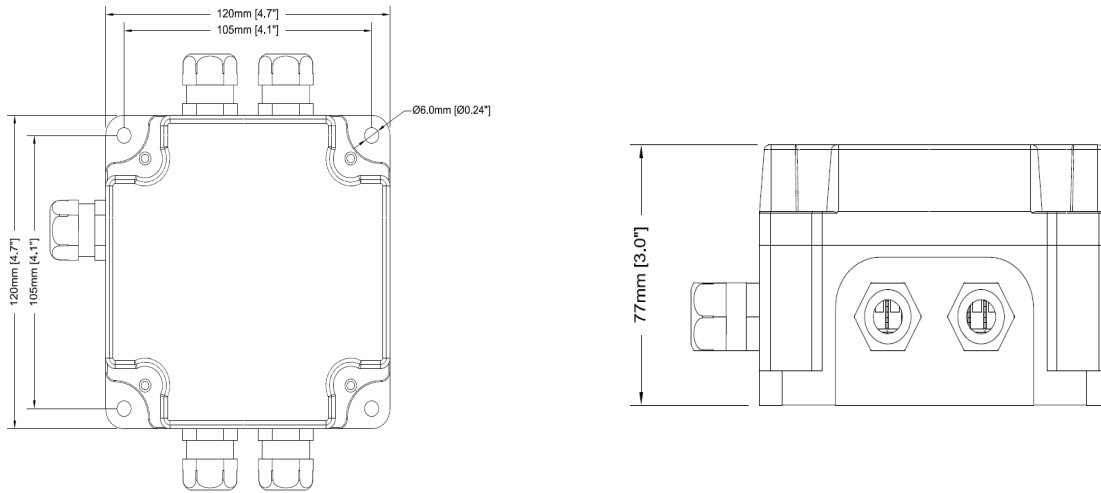

EIM - In2IT SERIES Enhanced Interface Module

ENGINEERING SPECIFICATIONS

ELECTRICAL REQUIREMENTS

Input Voltage:	90VAC – 250VAC; 50/60Hz
Current (Nominal): All Outputs Activated:	Max 750mA
Current (In-Rush): All outputs de-activated:	200mA
Fuse	2A

Dry Contact Outputs (Qty 4)

Relay Contact Type:	SPDT
Relay Contact Current:	6A

User Inputs (Qty 4)

Isolation:	IR optically isolated
Input Type:	Dry contact or logic

Speaker Volume Control

Transformer Taps:	1:1, 1:2, 1:4, 1:8
-------------------	--------------------

MECHANICAL SPECIFICATIONS

Plastic Housing (NL & Hazloc):	
Inside Dims (L x W xD):	6" [152mm] x 8" [203mm] x 4" [101mm]
Outside Dims (L x W xD):	6.5" [165mm] x 8.5" [216mm] x 4.5" [114mm]
Max # Conduits:	4
Est Weight:	12lbs [5.4kg]

ENVIRONMENTAL SPECIFICATIONS

Operating Temperature (General):	-58F to 194F [-50C to +90C]
Operating Temperature (IECEx):	-58F to 122F [-50C to +50C]
Water Resistance	IP67

COMPLIANCE

IECEx	Zone 2
-------	--------

ORDERING INFORMATION

Warranty: Five year parts and labor

Order No.	Description
P9014	EIM Module (General Locations)
P9015	EIM Module (IECEx Zone 2 Locations)

Distributed by:



GUARDIAN TELECOM LTD.
 Calgary, Alberta, Canada
 Telephone: 403 258-3100 Facsimile: 403 255-2595
 1-800-363-8010 (North America)
 info@guardiantelecom.com | www.guardiantelecom.com